

D U C T M A T E

Cornermatic+Plus™ Corners

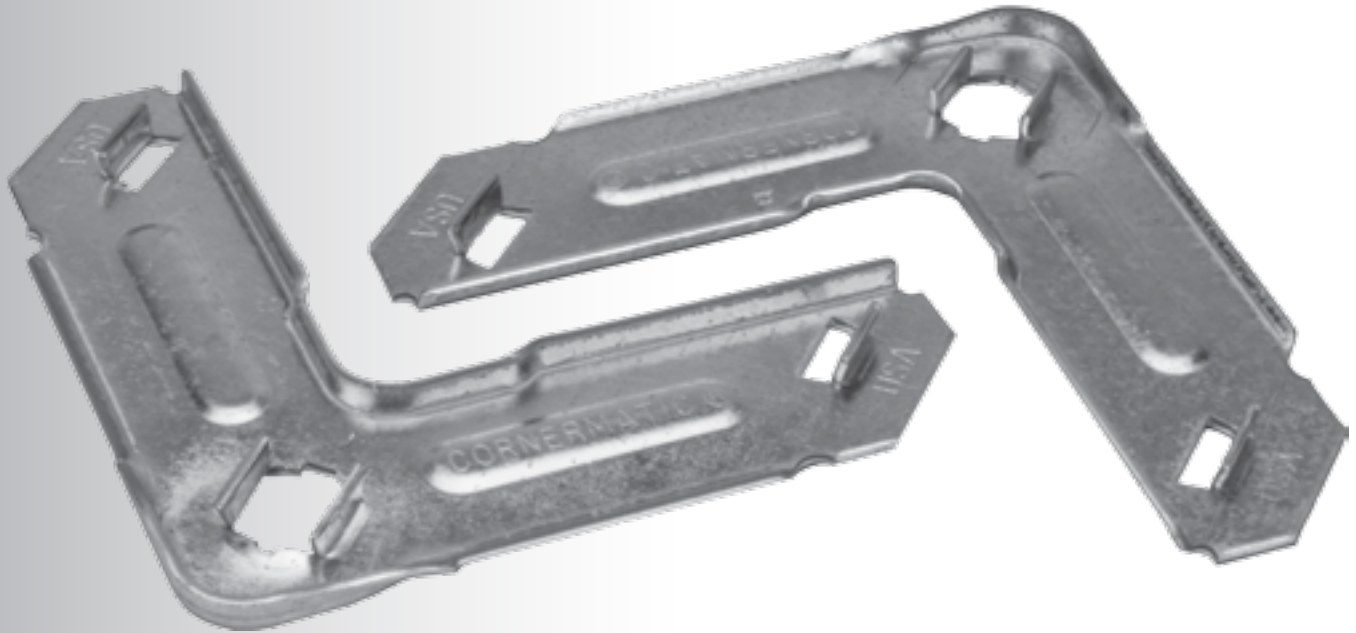

Save Time Loading / Inserting

Available for Both TDC® and TDF® Corners

- Developed for use with the Cornermatic+Plus or Retrofitted Cornermatic® Machines



Cornermatic+Plus™ Corners

**Save Time
Loading / Inserting**

BASIC USE

A new and innovative way of inserting Cornermatic® TDC® and TDF® corners. These corners can save time and improve corner insertion in two different ways:

- With Iowa Precision's new Cornermatic+Plus machine
- In a traditional Cornermatic machine with our retrofit conversion kit

TECHNICAL INFORMATION

Precision stamped from 16 gauge galvanized steel

Hole for 3/8" carriage bolt

Available in a variety of metals:

- GA - Galvanized
- GN - Galvanneal
- AL - Aluminum
- PVC - PVC coated
- S4 - 304 stainless steel
- S6 - 316 stainless steel

DIRECTIONS FOR USE

The new Cornermatic+Plus machine is a next generation corner solution from Iowa Precision which allows for speedy corner loading and insertion on a variety of styles of duct. With this table height work station, the corners are fed from below the work surface, eliminating the chance for interference between the duct and corner hopper. Ductwork with acute and obtuse angles, as well as ductwork with offsets and unusual bends can easily work with the new Cornermatic+Plus machine.



Traditional Cornermatic Dual head machines can be easily modified with a conversion kit to accept the Cornermatic+Plus sleeves. Load 80 corners in just seconds, eliminating the need to manually load individual corners into the machine. This saves time, and prevents accidental jamming due to corners being loaded upside down.



Corners are packed 80 per cardboard sleeve. Each box holds 4 cardboard sleeves (320 corners). 50 boxes can be loaded on a pallet.

LIMITED PRODUCT WARRANTY

Ductmate warrants that Cornermatic+Plus Corners, when properly installed and maintained, will be free from defects in material and workmanship, and will comply with all written specifications made by Ductmate at the time of sale. Ductmate's warranty shall run for a period of one year from the date of manufacture.

Warranty Limitation

The warranty stated above is in lieu of all other warranties, express or implied, including but not limited to the implied warranties of MERCHANTABILITY AND FITNESS FOR A PARTICULAR PURPOSE. Although Ductmate may have suggested the product, or provided written or oral advice to the Purchaser, it is the Purchaser's responsibility to test and determine the suitability of Cornermatic+Plus Corners, for the intended use and purpose, and Purchaser and/or its customer assumes all risk and liability whatsoever regarding such suitability.

Limitation of Liability

In the event of a breach of the above warranty, Ductmate's sole obligation, and Purchaser's sole and exclusive remedy, shall be, at Ductmate's option, repair or replacement of any defective products, or refund of an applicable portion of the purchase price. Ductmate shall have no liability for costs of removal or reinstallation of the product. The Purchaser agrees that no other remedy, including but not limited to loss of profits, loss sales, injury to person or property, or any other special, incidental or consequential damages, shall be available to the Purchaser for any claim arising out of this Agreement, regardless of whether such claim is made in contract or in tort, including strict liability in tort. In no event will Ductmate be obligated to pay damages to the Purchaser in any amount exceeding the purchase price that the Purchaser paid to Ductmate for the allegedly defective product.

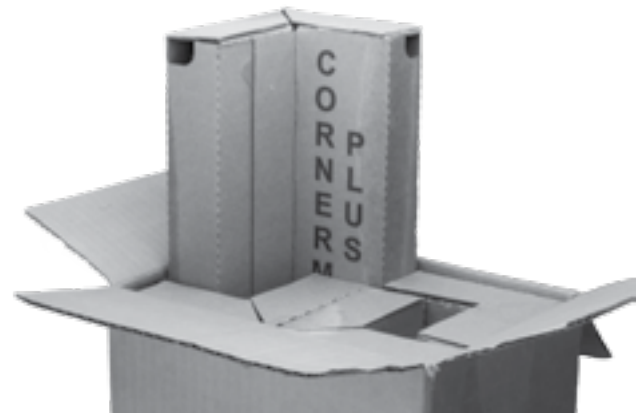

Charleroi, PA 210 Fifth Street
Charleroi, PA 15022
800-245-3188
724-258-0500
FAX: 724-258-5494

Lodi, CA 810 S. Cluff Avenue
Lodi, CA 95240-9141
800-245-3188
724-258-0500
FAX: 209-333-4678

www.ductmate.com



This spec data is printed on paper that meets the Certified Fiber Sourcing requirements of the SFI program and contains 10% recycled content

Distributed By:

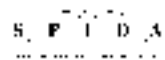

© Copyright Ductmate Industries, Inc. All rights reserved.

709 - 03-14